

# SEALED RECHARGEABLE LEAD-ACID

## B A T T E R I E S

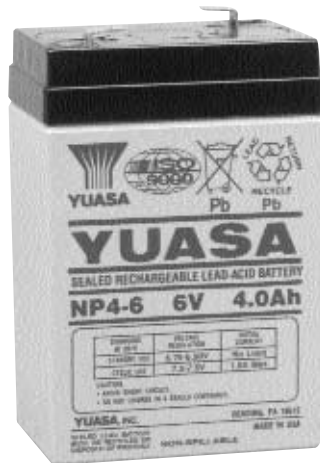

### YUASA

## NP4-6

### 6V, 4.0Ah

## Specifications

**NOMINAL VOLTAGE:** 6V

**NOMINAL CAPACITY:**

20 hour rate of 0.2A to 5.25V 4.0Ah

10 hour rate of 0.37A to 5.25V 3.7Ah

5 hour rate of 0.68A to 5.10V 3.4Ah

1 hour rate of 2.40A to 4.80V 2.4Ah

**WEIGHT (approx.)** 1.98 pounds (0.9 kgs.)

**ENERGY DENSITY (20 hr. rate):**

1.16 WH/cubic inch (71 WH/liter)

**SPECIFIC ENERGY (20 hr. rate):**

9.7 WH/pound (21.4 WH/kg)

**INTERNAL RESISTANCE OF CHARGED BATTERY:**

35 milliohms (approx.)

**MAXIMUM DISCHARGE CURRENT WITH STANDARD TERMINALS:**

40 amperes

**MAXIMUM SHORT-DURATION DISCHARGE CURRENT:**

120 amperes

**OPERATING TEMPERATURE RANGE:**

**CHARGE** 5°F to 122°F

(-15°C to 50°C)

**DISCHARGE** -4°F to 140°F

(-20°C to 60°C)

**CHARGE RETENTION (shelf life) at 68°F (20°C):**

**1 month** 97%

**3 months** 91%

**6 months** 85%

**LIFE EXPECTANCY:**

**STANDBY USE** 3 to 5 years

**CYCLE USE (approx.)**

**100% depth of discharge** 250 cycles

**50% depth of discharge** 550 cycles

**30% depth of discharge** 1200 cycles

**SEALED CONSTRUCTION:**

Can be operated in any position without leakage.

**STANDARD TERMINAL:**

Quick Disconnect .187

**HOUSING MATERIAL:** ABS Resin

## Dimensions

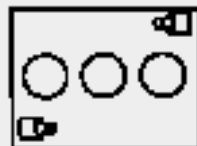

DIMENSIONS: MM (INCHES)

## Terminal

Optional 0.187)

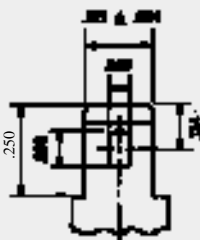

INCH = MM

.250 6.35

.185 4.70

.124 3.15

.098 2.49

.060 1.52

.031 0.79

.020 0.51

.004 0.10

DIMENSIONS: INCHES



RECOGNIZED BY UL, File No. MH 16464

## DISCHARGE CHARACTERISTICS CURVES AT 25°C (77°F)

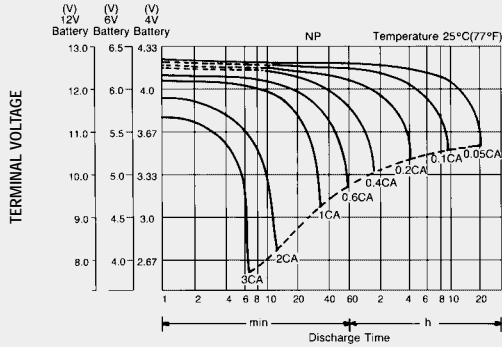

## TEMPERATURE EFFECTS IN RELATION TO BATTERY CAPACITY

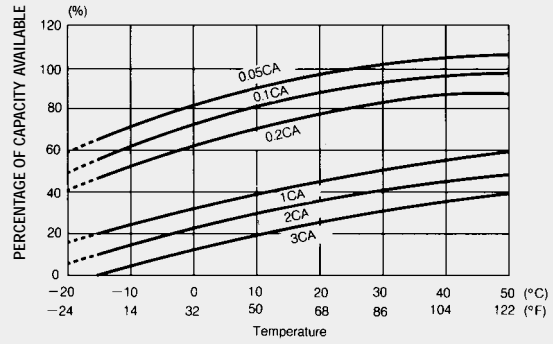

## SELF DISCHARGE CHARACTERISTICS

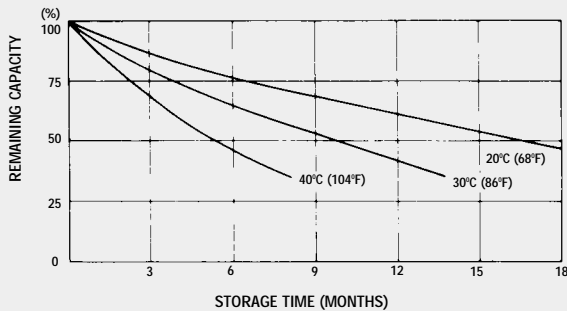

## OPEN CIRCUIT VOLTAGE VS REMAINING CAPACITY

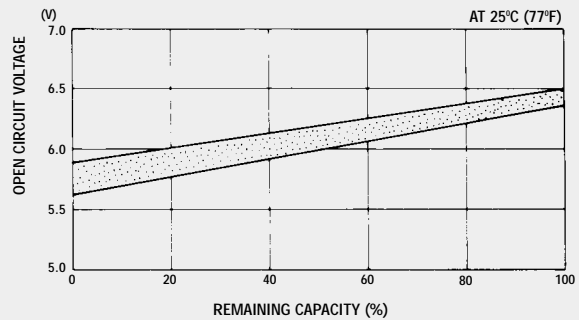

## CYCLE SERVICE LIFE IN RELATION TO DEPTH OF DISCHARGE

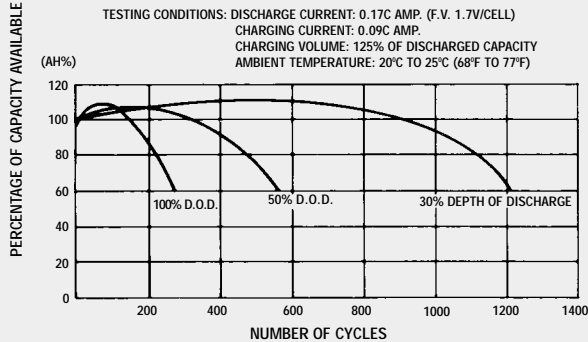

## FLOAT SERVICE LIFE

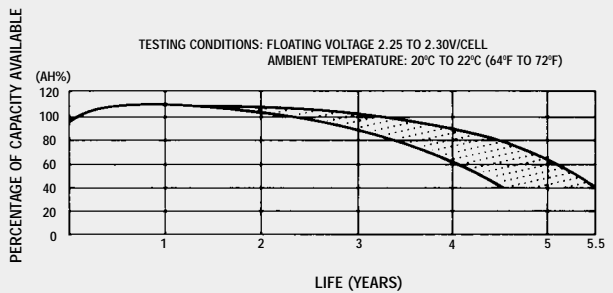

When the battery will be used by the current in excess of 3C, consult with EnerSys Inc. prior to use.

**CHARGING METHODS (At 20°C) Cycle use:** Maximum charging current 1.0A  
 Charging voltage 7.2 to 7.5V

**Standby use:** Float charging voltage 6.75 to 6.90V

**CAUTION**

- Avoid short circuit
- Do not charge in a sealed container.

Represented by:

When ordering new batteries, also remember to properly recycle your old lead batteries. Federal and state regulations require lead-acid batteries be recycled. EnerSys' nationwide service organization can arrange pickup, transportation to and recycling at any one of our company affiliated smelters. Call 1-800-972-7372 for more information.



**EnerSys**

Powerful Solutions

**Global Headquarters:**

P.O. Box 14145, Reading, PA 19612-4145  
 1-610-208-1991 • 1-800-538-3627  
 FAX 1-610-372-8613

**US Sales Offices**

Eastern Region: 1-201-964-0118 • 1-800-962-1287  
 Western Region: 1-562-949-4266 • 1-800-423-4667

**Regional Sales Offices**

EnerSys Canada: 1-905-790-1212  
 ESB de Mexico SA DE: 52-8-329-6405

EnerSys Inc. has locations worldwide to serve your needs; for additional information please visit our website at [www.enersysinc.com](http://www.enersysinc.com) or contact us at 1-800-538-3627.