

Independence™**SEALED RECHARGEABLE LEAD-ACID****B A T T E R I E S**

YUASA
 Power/Full Solutions™

NP12-12
NP12-12FR
12V, 12.0Ah

Specifications

NOMINAL VOLTAGE: 12V**NOMINAL CAPACITY:**

20 hr. rate of 0.6A to 10.50V 12.0Ah

10 hr. rate of 1.1A to 10.50V 11.0Ah

5 hr. rate of 2.1A to 10.20V 10.5Ah

1 hr. rate of 7.2A to 9.60V 7.2Ah

WEIGHT (approx): 8.82 pounds (4 kgs.)**ENERGY DENSITY (20 hr. rate):**

1.70 WH/cubic inch (103.5 WH/liter)

SPECIFIC ENERGY (20 hr. rate):

16.3 WH/pound (36.0 WH/kg)

INTERNAL RESISTANCE OF CHARGE:

16 milliohms (approx.)

MAXIMUM DISCHARGE CURRENT**WITH STANDARD TERMINALS:**

40 amperes

MAXIMUM SHORT-DURATION**DISCHARGE CURRENT:**

360 amperes

OPERATING TEMPERATURE RANGE:**CHARGE** 5°F to 122°F

(-15°C to 50°C)

DISCHARGE -4°F to 140°F

(-20°C to 60°C)

CHARGE RETENTION (shelf life) at 68°F (20°C):**1 month** 97%**3 months** 91%**6 months** 85%**LIFE EXPECTANCY:****STANDBY USE** 3 to 5 years**CYCLE USE:****100% depth of discharge** 200 cycles**50% depth of discharge** 550 cycles**30% depth of discharge** 1200 cycles**SEALED CONSTRUCTION:**

Can be operated in any position without leakage.

STANDARD TERMINAL:

Quick disconnect .250

HOUSING MATERIAL:Container/cover made from ABS Resin or optional
Flame Retardant ABS (UL94-V0/L.O.I.>30%)

DIMENSIONS

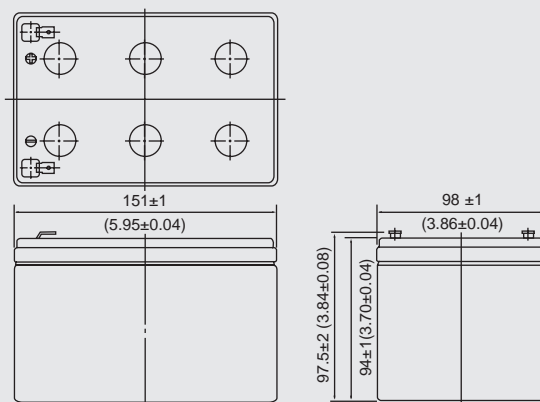

DIMENSIONS: MM (INCHES)

TERMINAL

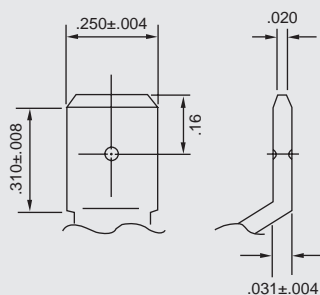

INCH	=	MM
.310		7.90
.250		6.35
.16		4.0
.031		0.8
.020		0.5

DIMENSIONS: (INCHES)



RECOGNIZED BY UL, File No. MH 12970

DISCHARGE CHARACTERISTIC CURVES

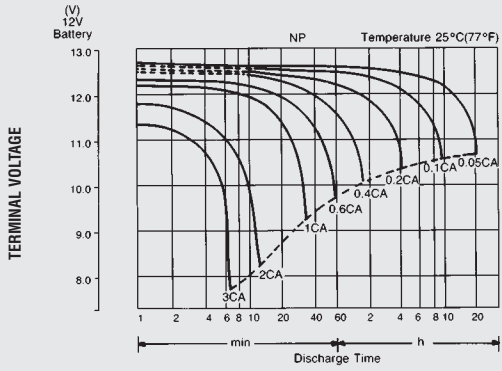

TEMPERATURE EFFECTS IN RELATION TO BATTERY CAPACITY

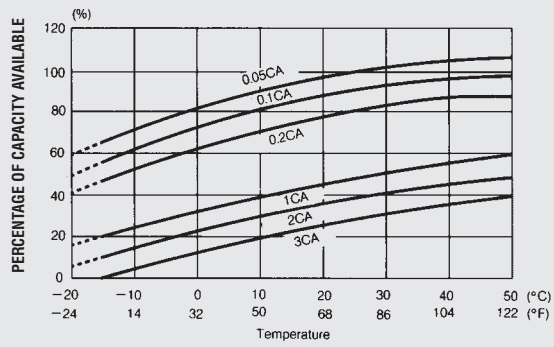

SELF DISCHARGE CHARACTERISTIC

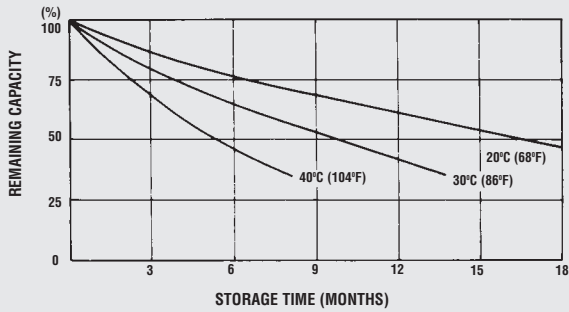

OPEN CIRCUIT VOLTAGE VS REMAINING CAPACITY

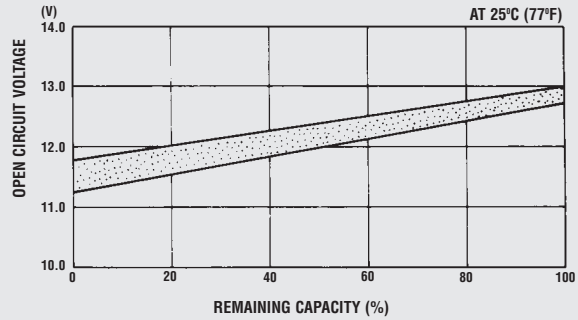

CYCLE SERVICE LIFE IN RELATION TO DEPTH OF DISCHARGE

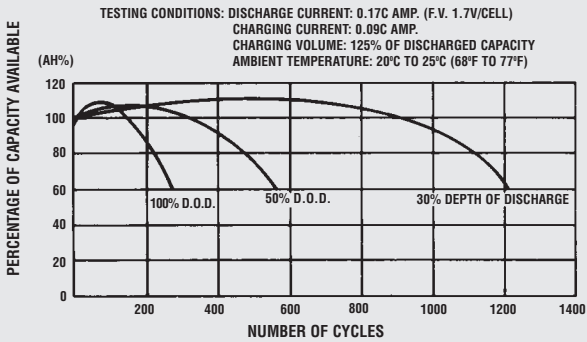

FLOAT SERVICE LIFE

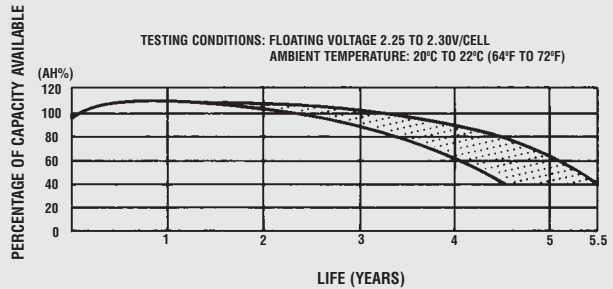

When the battery will be used by the current in excess of 3C, consult with Yuasa, Inc. prior to use.

CHARGING METHODS (At 20°C)

Cycle use:

Maximum charging current 3.0A

Charging voltage 14.4 to 15.0V

Standby use:

Float charging voltage 13.50 to 13.80V

CAUTION

- Avoid short circuit
- Do not charge in a sealed container.

Represented by:

When ordering new batteries, also remember to properly recycle your old lead batteries. Federal and state regulations require lead-acid batteries be recycled. Yuasa's nationwide service organization can arrange pickup, transportation to and recycling at any one of our company affiliated smelters. Call 1-800-972-7372 for more information.



Power/Full Solutions™

Sales Offices

Eastern Region: 201-964-0118 • 1-800-962-1287
 FAX 201-964-0720

Western Region: 562-949-4266 • 1-800-423-4667
 FAX 562-949-5527

Corporate Office: P.O. Box 14145, Reading, PA 19612-4145
 FAX 610-372-8613

Visit us on the web at: www.yuasastationary.com

Please check our website for literature updates